

## Accessories

### Hardware

#### Bayonet Fittings

Continued

#### Bayonet Adapter

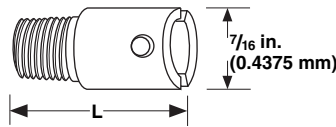

| Part No. | Description     | L Length in. | Thread in. |
|----------|-----------------|--------------|------------|
| TH-295-1 | Bayonet Adapter | 7/8          | 1/8        |
| TH-295-2 |                 | 1            | 1/8        |
| TH-295-3 |                 | 1 1/2        | 1/8        |
| TH-295-4 |                 | 2            | 1/8        |
| TH-295-5 |                 | 2 1/2        | 1/8        |
| TH-298-1 |                 | 7/8          | 3/8-24     |
| TH-298-2 |                 | 1 1/2        | 3/8-24     |

#### Pipe Clamp with Bayonet Adapter

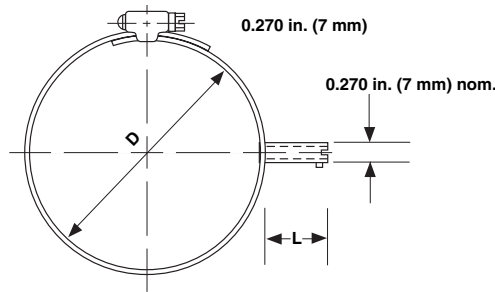

The pipe clamp band with bayonet adapter is designed for use in conjunction with a bayonet style thermocouple. It allows temperature measurement without drilling or tapping. Thermocouple replacement is extremely fast and simple and is accomplished without disturbing the surroundings, such as pipe insulation.

#### 1-2. Construction Code

90 = Pipe clamp band with bayonet adapter

#### 3. "D" Clamp Band Diameter Range (inch)

- A = 1/8 to 1 1/4
- B = 1 1/4 to 2 1/4
- C = 2 1/4 to 3 1/4
- D = 3 1/4 to 4 1/4
- E = 4 1/4 to 5
- F = 5 to 6
- G = 6 to 7

#### 4. "L" Bayonet Adapter Length inches

- 1 = 1 (use with thermocouple that has "B" dimension = 2 inch)
- 2 = 2 (use with thermocouple that has "B" dimension = 3 inch)

All combinations are available for next day shipment.

1 2 3 4  
9 0

**Note:** All accessories subject to minimum purchase quantities.

## Accessories

### Hardware

#### Transition Fittings and Accessories

Watlow's complete line of stainless steel transition fittings offers durable, potted connections between XACTPAK® type sheathed thermocouple material and insulated wire. When the distance between the thermocouple and the instrument is known in advance, this type of assembly can be connected directly to your instrument, minimizing field installation time.

When making a sensor with a transition fitting, the thermocouple and connecting wires are first securely brazed together. The appropriate transition body is then positioned over the splice and either crimped or brazed to the sheath material. The transition body is then filled with a potting compound which effectively insulates and strengthens the splice.

A coiled spring strain relief on the 700 and 701 protects the connecting wire against sharp bends at the transition area.

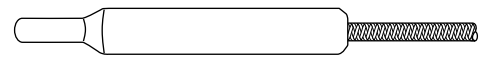

702 Transition Fitting

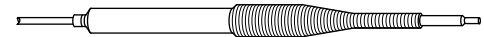

700 or 701 Transition Fitting, Assembled  
U.S. Patent Number 3,811,958



703 Heavy Duty Transition

| Part No. | Sheath O.D.<br>in. | Max. Dia.<br>Extension Wire | Transition Body inches |                                | Spring<br>Strain<br>Relief | Length<br>Including Spring<br>in. | Method of<br>Attachment<br>to Sheath |
|----------|--------------------|-----------------------------|------------------------|--------------------------------|----------------------------|-----------------------------------|--------------------------------------|
|          |                    |                             | O.D.                   | Length Less<br>Spring (if any) |                            |                                   |                                      |
| 702-020* | 0.020              | 0.100                       | $\frac{5}{32}$         | 1                              | no                         | —                                 | Braze                                |
| 702-032  | 0.032              | 0.100                       | $\frac{5}{32}$         | 1                              | no                         | —                                 | Braze                                |
| 700-040* | 0.040              | 0.136                       | $\frac{1}{4}$          | $1 \frac{3}{16}$               | yes                        | $2 \frac{1}{4}$                   | Crimp or braze                       |
| 702-040  | 0.040              | 0.100                       | $\frac{5}{32}$         | 1                              | no                         | —                                 | Braze                                |
| 700-063  | 0.063              | 0.136                       | $\frac{1}{4}$          | $1 \frac{3}{16}$               | yes                        | $2 \frac{1}{4}$                   | Crimp or braze                       |
| 701-063  | 0.063              | 0.210                       | $\frac{3}{8}$          | $1 \frac{3}{16}$               | yes                        | $2 \frac{1}{2}$                   | Crimp or braze                       |
| 702-063  | 0.063              | 0.100                       | $\frac{5}{32}$         | 1                              | no                         | —                                 | Braze                                |
| 700-125  | 0.125              | 0.136                       | $\frac{1}{4}$          | $1 \frac{3}{16}$               | yes                        | $2 \frac{1}{4}$                   | Crimp or braze                       |
| 701-125  | 0.125              | 0.210                       | $\frac{3}{8}$          | $1 \frac{3}{16}$               | yes                        | $2 \frac{1}{2}$                   | Crimp or braze                       |
| 701-188  | 0.188              | 0.210                       | $\frac{3}{8}$          | $1 \frac{3}{16}$               | yes                        | $2 \frac{1}{2}$                   | Crimp or braze                       |
| 701-250  | 0.250              | 0.210                       | $\frac{3}{8}$          | $1 \frac{3}{16}$               | yes                        | $2 \frac{1}{2}$                   | Crimp or braze                       |
| 703-250  | 0.250              | 0.320                       | $\frac{1}{2}$          | 2                              | no                         | —                                 | Braze                                |

\*Sleeved down from larger size to accept smaller O.D. sheath material.

**Note:** All accessories subject to minimum purchase quantities.